

OREGON PUBLIC LAND CORNER REPORT / RESTORATION REPORT
Tillamook County Surveyor's Office

BOOK 8 211

SECTION: 28 and 33	TOWNSHIP: 1 South	RANGE: 10 West
COUNTY: Tillamook		DATE: 11/23/2024
CORNER DESIGNATION: The Quarter corner common to Sections 28 and 33, Township 1 South, Range 10 West; Willamette Meridian		(Please check one)
		<input type="checkbox"/> Condition Report Only
		<input type="checkbox"/> Restoration
		<input checked="" type="checkbox"/> Rewitness
		<input type="checkbox"/> Unrecorded
		<input type="checkbox"/> Reset at surface
		<input type="checkbox"/> Referenced Out

Previous Rewitnesses, Restorations and Surveys, etc...
BLM field note volume: OR-R0337 Page 0275.00 (1890)
Rewitness Book 7, Page 175 (1993)

History, condition, and sources
BLM field note volume: OR-R0337 Page 0275.00 (1890) states the corner as being a post 4' long, 4" square, 2' deep marked "1/4 S on North face from which 2 bearing trees were established. In 1993 (Rewitness bk. 7 pg. 175) The Tillamook Surveyors office found the original monument missing and reestablished the 1/4 corner using an original GLO bearing tree to put it back to its original position. The Tillamook County Surveyor set a 1 1/2" iron pipe with a 3" Tillamook County Brass cap stamped "T1SR10W 1/4 S28 S33 LS793 1993" in a 10" concrete cylinder. The County Surveyors office also established 4 new accessories. In 2024 The Tillamook County Surveyors office found the 1/4 Corner a 3" Tillamook County brass cap stamped "T1SR10W 1/4 S28 S33 LS793 1993" incased in a 10' concrete cylinder as shown hereon. The found record accessories are listed below.

Found: (BLM field note volume: OR-R0337 Page 0275.00) 72" dia. spruce S71°E 44lks 29.04' (Rewitness bk. 7 pg. 175 1993) 96" dia. Spruce stump 10' tall S71°E 44lks 29.04' partial scribe visible "1/4S BT" 10" deep in chopped out face. **Now** 96" dia. Spruce stump 10' tall S71°E 44lks 29.04' with yellow metal location tag in the cut-out face.

Found: (Rewitness bk. 7 pg. 175 1993) 72" light hat section post East 450' at the top of a cut bank West side of road.

New accessories set:

Monument was tied directly using GPS in Oregon North Zone NAD 83/91 grid coordinates in US Survey feet. Coordinates provided hereon are given in WGS 84 Latitude and Longitude.

Latitude: 45°26'57.16343"
Longitude: -123°55'02.84690"

Set: 96" metal hat section post with yellow metal location tag West 1.4'

No new bearing tress available.

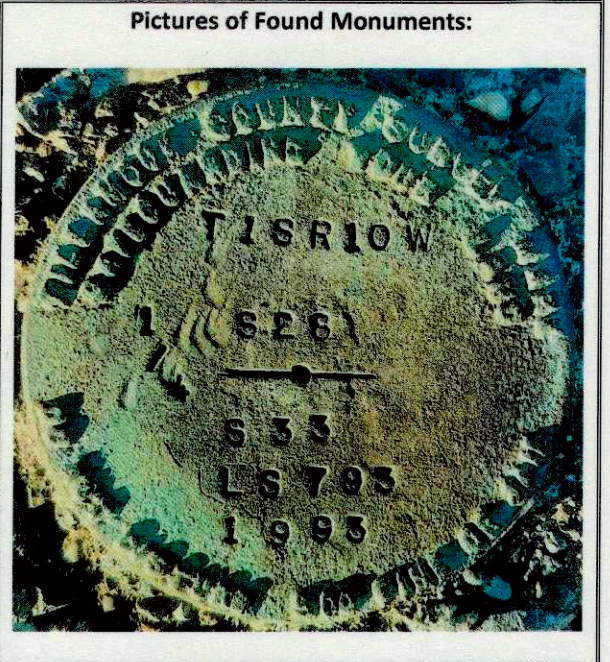
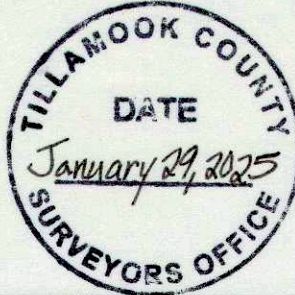

Location: ± 1.5 miles on logging road #600 off Netarts HWY. ±450' west of logging road #600 and ±300' North of unnumbered logging road.

Tillamook County Surveyor office: 1510 3rd Street Suite C, Tillamook, OR. 97141

Party Chief: Travis Porter, Tillamook County Surveyors Office

Witnesses: Michael Rice P.L.S. 86926, Tillamook County Surveyor
Kael Poklikuha, Tillamook County Survey Technician

Notes: Digital images taken of monument and accessories.

SURVEYOR'S SEAL

REGISTERED
PROFESSIONAL
LAND SURVEYOR

Michael Rice

OREGON
DECEMBER 11, 2012
MICHAEL R. RICE
86926
RENEWAL 12-31-2026

BOOK 8 211